



MOVE INN ESTATES

MAKING THE RIGHT MOVE



Laburnum Road
Hayes, Middlesex, UB3 4JZ
Price Guide £435,000



Floor Plan

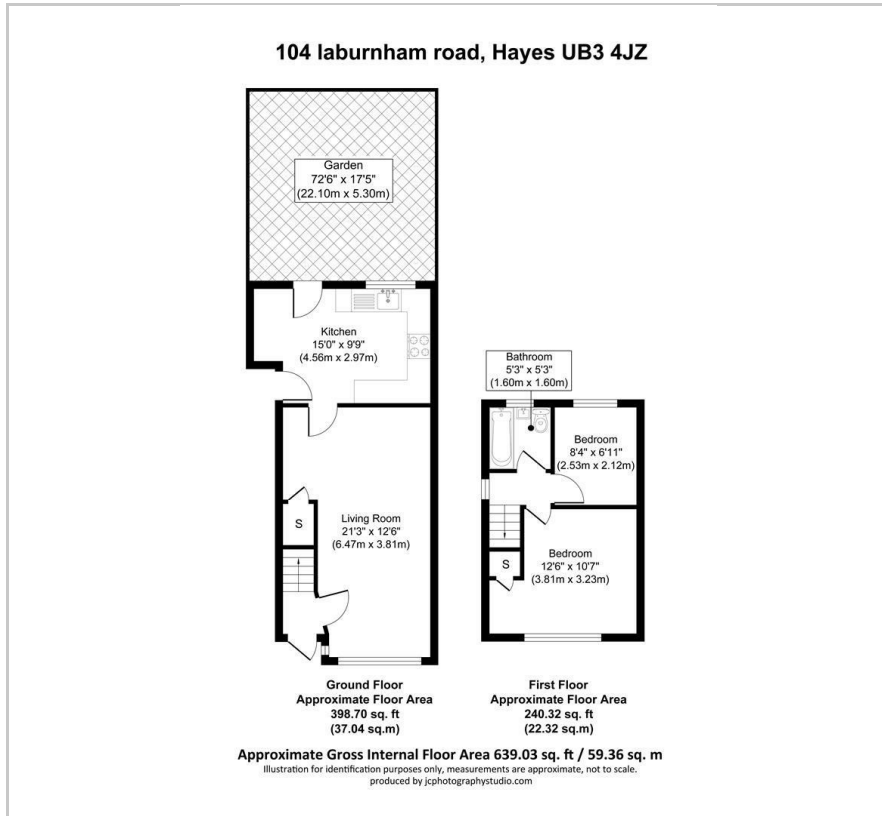

Area Map



Energy Efficiency Graph

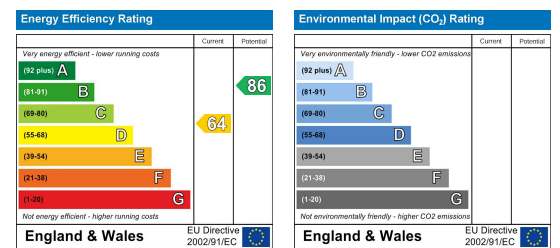

Viewing

Please contact our Move Inn Estates - Sales Office on 0208 574 4966 if you wish to arrange a viewing appointment for this property or require further information.

- Chain free
- End terrace
- Large garden
- Two bedrooms
- Driveway
- Fitted kitchen



CHAIN FREE! Move Inn Estates are pleased to offer to the market, this spacious two bedroom end terrace property located in reach of local amenities.

The property consists of a bright reception room, modern fitted kitchen, two double bedrooms, family bathroom and plenty of storage space. It also benefits from a large private front garden with off road car parking, and a laid to lawn private garden. Ideal for investors or first time buyers.

Located in South Hayes off of Roseville Road which in turn is just of North Hyde Road. Less than a mile from Hayes/Harlington main line station which will greatly benefit from the new Crossrail link, Hayes Town Centre for local shopping, schools and E6 and 195 bus routes as well as the Hayes By Pass and M4.

Viewings advised.



These particulars, whilst believed to be accurate are set out as a general outline only for guidance and do not constitute any part of an offer or contract. Intending purchasers should not rely on them as statements of representation of fact, but must satisfy themselves by inspection or otherwise as to their accuracy. No person in this firm's employment has the authority to make or give any representation or warranty in respect of the property.